

Recommended Panel Cut Out

Frequency:

Frequency range: 0 to 11 GHz (50Ω)
0 to 1 GHz (75Ω)

VSWR: ≤1.3 (straight connector)
≤ 1.35 (right angle connector)

Insertion Loss (dB): 0.177 under 6GHz (50 ohm)
0.177 under 1GHz (75 ohm)

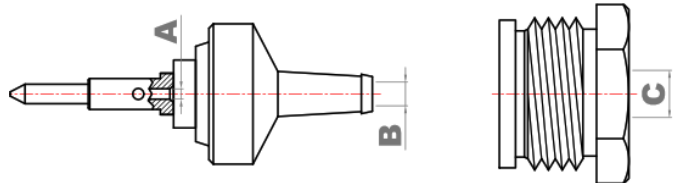

Electrical:

Impedance: 50/75 ohm

Voltage Rating: ≥500 V rms (Depending on cable)

Insulator Resistance : ≥ 5 GΩ

Dielectric Withstanding Voltage : 1500 V rms

Contact Resistance : Center Contact ≤ 1.5 mΩ

Outer Contact ≤ 1 mΩ

PN
index

Cable Type	Dimensions		
	A	B	C
RG174,316	0.7	1.7	3.3

0

Mechanical:

Mating : 7/16 - 28UNEF Screw-on Coupling

Recommended Mating Torque: 4.1 lbs ~ 6.1 lbs

Coupling Nut Retention Force: ≥101.2 lbs

Cable Retention Force: ≥ 12.1 lbs (for RG316)

≥ 28.7 lbs (for RG58)

≥ 38.3 lbs (for RG59)



Environmental:

Temperature Range : -55°C to 155°C

Corrosion (Salt Spray) : MIL-STD-202,

Method 101, Cond.B

Vibration : MIL-STD-202, Method 204, Cond.B

Thermal Shock : MIL-STD-202, Method 107, Cond.B

Mechanical : MIL-STD-202, Method 213, Cond.G

Notes:

1- The overall contour may be slightly changed per terminating with different cable and we reserve right to change it without notice.

2- Any changes for interface dimensions are strictly prohibited.

3- The Material and plating are in various options per customer's request.

4- A complete information for connectors is available upon request.

Tolerances	Scale	Abbr.	Rev.	Part Number	F141-127X PN index above	
.X ±0.2 .XX ±0.1 .XXX ±0.05	NTS	ST	B			
PAGE	All Dimensions in mm (Unless Otherwise Specified)			Date		
1 of 1				2021/08/23		