

## Specification:

Operating Voltage:	12V, 24V, 28V
Switching Time:	20 ms max
Operating Current:	360 mA
Work Temperature:	-45 to +85 °C
Life cycle:	1.000.000 cycles
Control TTL:	TTL High for Loss, Low for Isolation
Impedance:	50 Ω
Connector Type:	SMA-F
Case type (mm):	L*32*32
Weight:	150g

\*\*\* NOTE1: L=37mm (Failsafe)

NOTE2: L= 46mm (Latching)

## Electrical Characteristic:

Frequency Range ( GHz)	VSWR	Isolation (dB)	Insertion Loss (dB)	Power Handling (Watt)
DC-3	<1.2	>80	<0.2	100
3-6	<1.3	>70	<0.3	70
6-12.4	<1.4	>60	<0.4	50
12.4-18	<1.5	>60	<0.5	40

<b>Tolerances</b> .X ±0.2 .XX ±0.1 .XXX ±0.05	Scale	Abbr.	Rev.	<b>Website:</b> <a href="http://www.iprece.com">www.iprece.com</a> <b>Email:</b> <a href="mailto:info@iprece.com">info@iprece.com</a>	
	NTS	ST	B		
PAGE <b>1 of 2</b>	<b>All Dimensions in mm</b> (Unless Otherwise Specified)			Date	
				2021/08/17	

## Case type (mm):

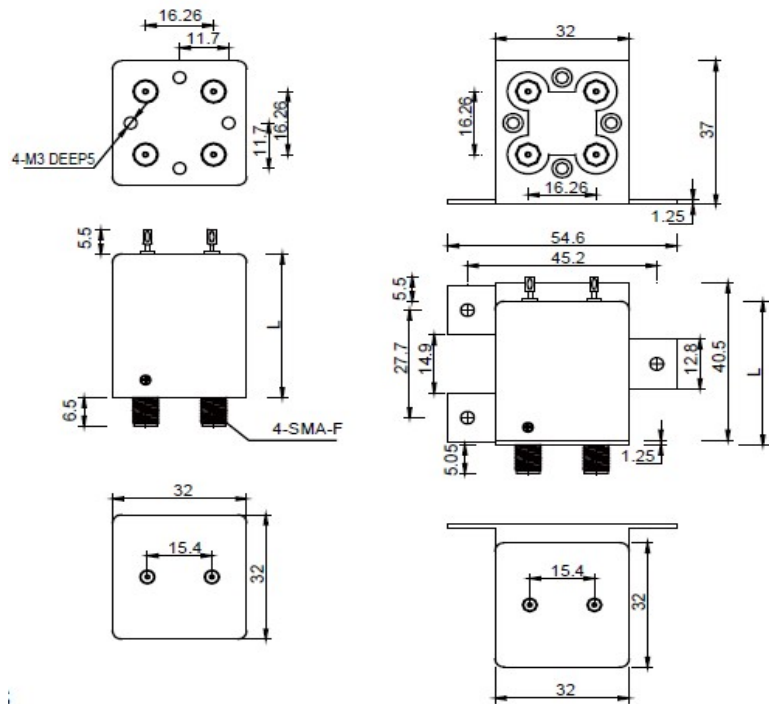

Not1:L=37mm (failsafe)  
 Note2:L=46mm( latching)

## How To Order:

### Part Numbering

DPDTFS **X** **X** **X**

### DC Power:

- 1=12VDC
- 2=24VDC
- 3=28VDC

### Freq Range:

- A=3GHz
- B=6GHz
- C=12.4GHz
- D=18GHZ

### Driver:

M=without driver only voltage control not TTL

Blank: with TTL control

Tolerances .X ±0.2 .XX ±0.1 .XXX ±0.05	Scale	Abbr.	Rev.	Website: <a href="http://www.iprece.com">www.iprece.com</a> Email: <a href="mailto:info@iprece.com">info@iprece.com</a>	
	NTS	ST	B		
PAGE <b>2 of 2</b>	All Dimensions in mm (Unless Otherwise Specified)			Date 2021/08/17	