

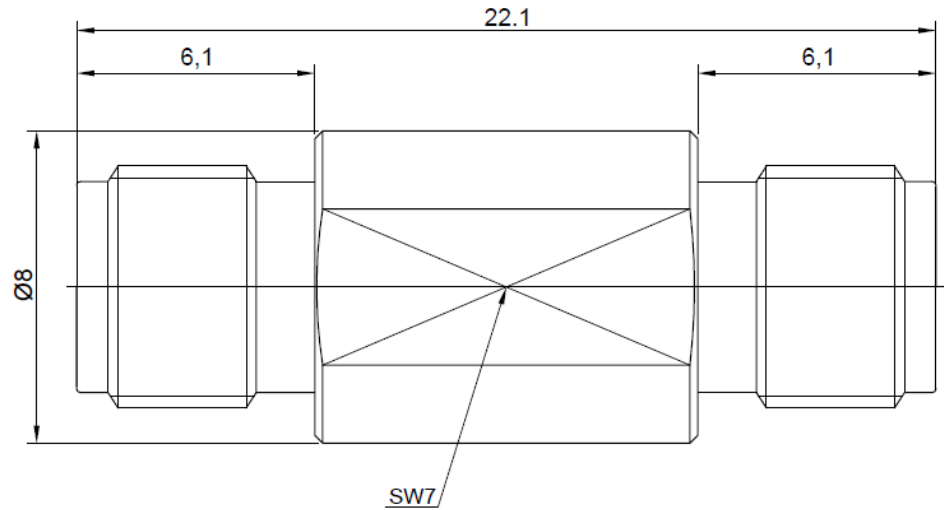

SMA Female To SMA Female Straight RF Coaxial Adapter



Frequency:

Frequency range: DC ~18 GHz

VSWR: ≤ 1.2

Electrical:

Impedance: 50 ohm

Working Voltage : 1000 V rms

Insulator Resistance : $\geq 5 \Omega$

Durability: ≥ 500 Times



Material & Finishes:

Center Contact: Beryllium Copper/Gold

Outer contact: Brass/Gold

Insulators: PTFE

Notes:

1- The overall contour may be slightly changed per terminating with different cable and we reserve right to change it without notice.

2- Any changes for interface dimensions are strictly prohibited.

3- The Material and plating are in various options per customer's request.

4- A complete information for connectors is available upon request.

Environmental:

Temperature Range : -40°C to 125°C

Tolerances .X ±0.2 .XX ±0.1 .XXX ±0.05	Scale	Abbr.	Rev.	Part Number AD03-010Z	
	NTS	ST	B		
PAGE 1 of 1	All Dimensions in mm (Unless Otherwise Specified)			Date 2021/06/10	